

# 667

## 21st Floor



THE VIEW

61ST STREET

**SUITE AVAILABLE:**  
August - September 2018

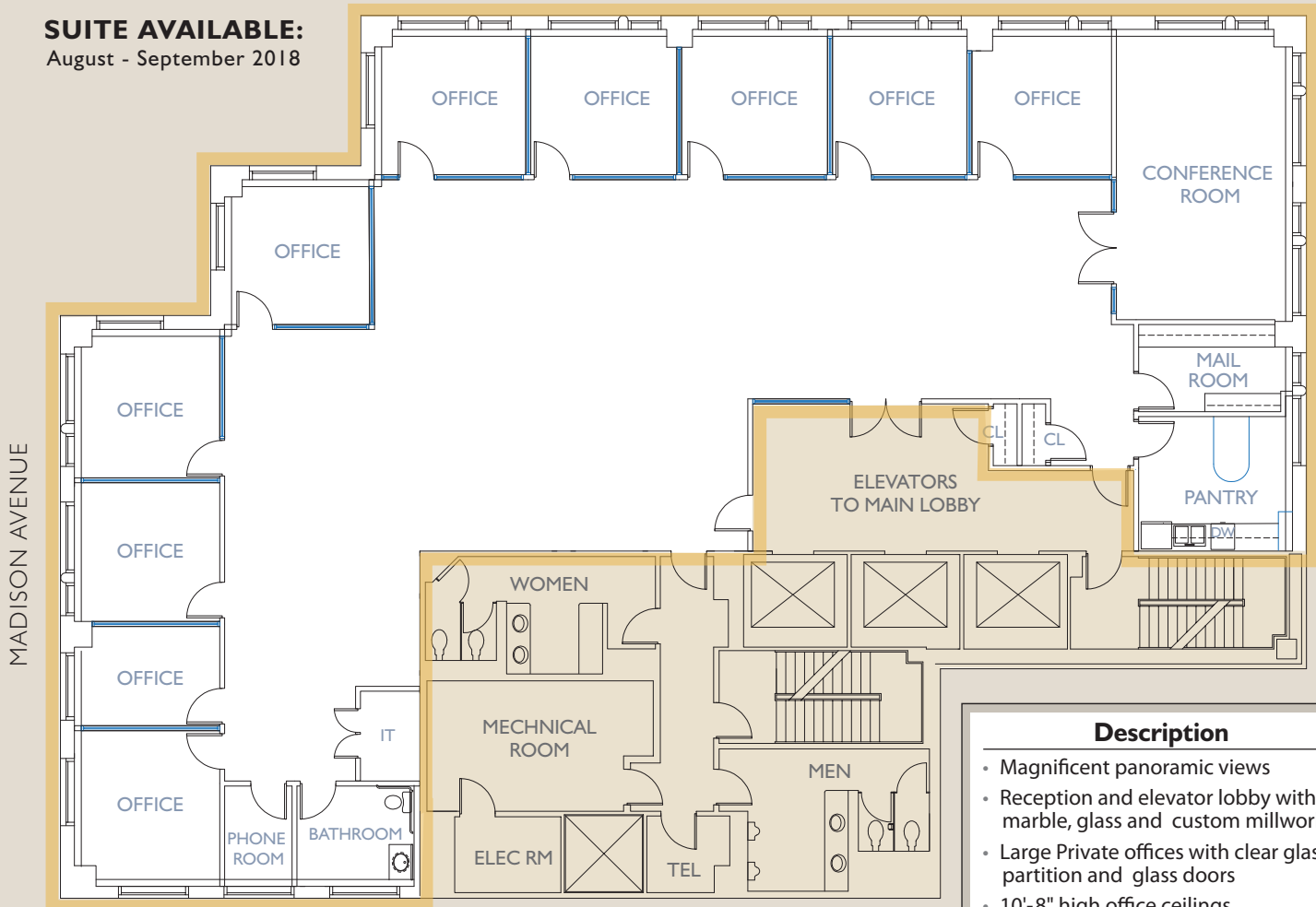

MADISON AVENUE

GRAPHIC SCALE



### Description

- Magnificent panoramic views
- Reception and elevator lobby with Italian marble, glass and custom millwork
- Large Private offices with clear glass partition and glass doors
- 10'-8" high office ceilings
- Decorative energy efficient LED lighting throughout
- Modern pantry with buffet serving area with high-end built-in appliances
- Private accessible bathroom
- Wireless electronic window blinds
- Pre-built mailroom with premium millwork finishes
- Broadloom carpeting throughout
- Cat 6 wiring
- Private golf simulator room
- In-house fitness center

0518

For further information and inspection,  
please contact:

Samia Bali: 212.308.3336 • samia.bali@hartzmountain.com

**The Hartz Group, Inc.**

667 Madison Avenue, New York, New York, 10021

212.308.3336 - Phone • 212.838.8845 - Fax • [www.667madison.com](http://www.667madison.com)